

Single fulcrum hinge

For door weight up to 10Kg

Applications

✓
Ovens

Geometry

✓
Footprint: W, H, L
Fulcrum position (respect to the base): X, Y
Parallel dimension (between base and receiver): Q

Technical features

✓
Fulcrum position - Rotation X=14mm Y=5.3mm
Parallel dimension (between base and receiver) Q: 23.7mm
Footprint: W=22mm, H=19.3mm, L=206.8mm
Type of fixing: Lateral

Functionality

✓
Balancing: 0 - 86°
Closing forces: 30 - 70N depending on the application and customer needs
Broil position: available at 23°
Pre-load position: available at 50°

Removability

✓
Using the extraction hook with the door open

Performance

✓
Operating temperature: 130°C
Resistance to static load: till 34Kg
Dynamic test: till 25k cycles

Compliance

✓
Hinge complies with VDE anti-crushing regulations

Receiver

✓
Possibility for the customer to define his own receiver or integrate it with the oven structure

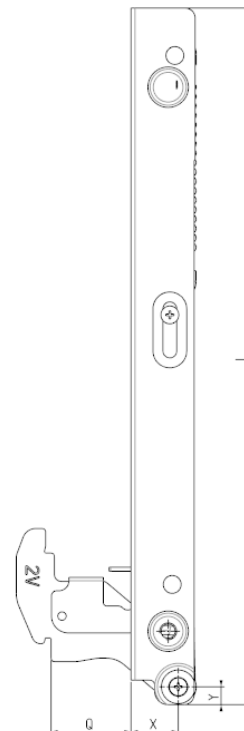
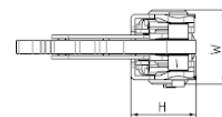

2D Drawing

✓
The following drawing shows the main functional dimensions.
Possibility of customized designs based on customer needs

