

# Single fulcrum hinge

For door weights up to 10Kg

## Applications

✓  
Ovens

## Geometry

✓  
Footprint: W, H, L  
Fulcrum position (respect to the base): X, Y  
Parallel dimension (between base and receiver): Q

## Technical features

✓  
Fulcrum position - Rotation X=14mm Y=7mm  
Parallel dimension (between base and receiver) Q: 18.6mm  
Footprint: W=24mm, H=19mm, L=197mm  
Type of fixing: upper and frontal holes

## Functionality

✓  
Balancing: 0 - 86°  
Closing forces: 30 - 70N depending on the application and customer needs  
Pre-load position: available at 50°

## Removability

✓  
Using the extraction hook with the door open

## Performance

✓  
Operating temperature: 130°C  
Resistance to static load: till 34Kg  
Dynamic test: till 25k cycles

## Compliance

✓  
Hinge complies with VDE anti-crushing regulations

## Receiver

✓  
Distance between holes for fixing F= 91mm  
Possibility of lateral fixings: no  
Possibility for the customer to define his own receiver or integrate it with the oven structure

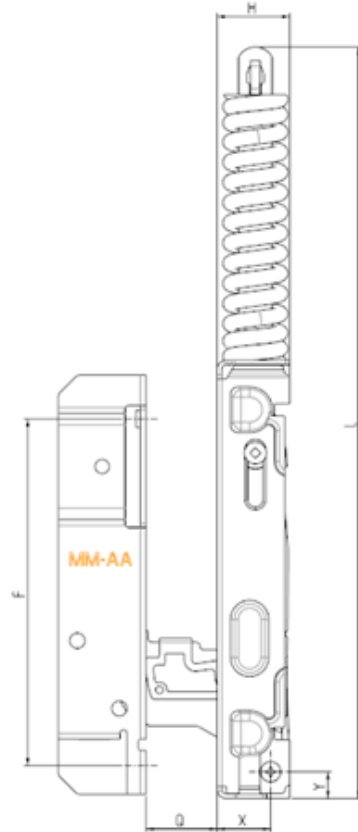
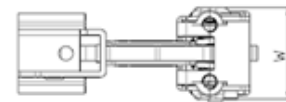

2D Drawing

✓  
The following drawing shows the main functional dimensions.  
Possibility of customized designs based on customer needs

